

TRANSFORMERS

MASTERPIECE GRIMLOCK™

LEVEL: 0 1 2 3 4 5
ADVANCED

AUTOBOT®

NOTE: Some parts are made to detach if excessive force is applied and are designed to be reattached if separation occurs. Adult supervision may be necessary for younger children.

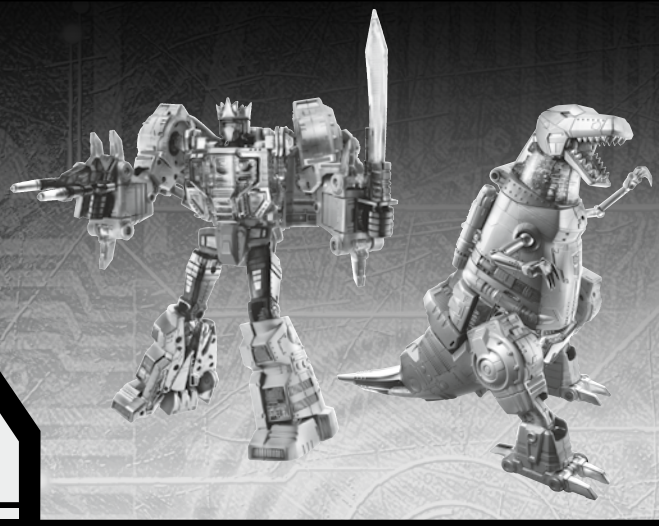

WARNING:
CHOKING HAZARD—Small parts.
Not for children under 3 years.

AGES 5+

97684

x2 A76 or LR44 Alkaline
BATTERIES INCLUDED

Replace with 2 x 1.5V "A76" or LR44 size alkaline batteries. Phillips/cross head screwdriver (not included) needed to replace batteries.

CHANGING TO ROBOT

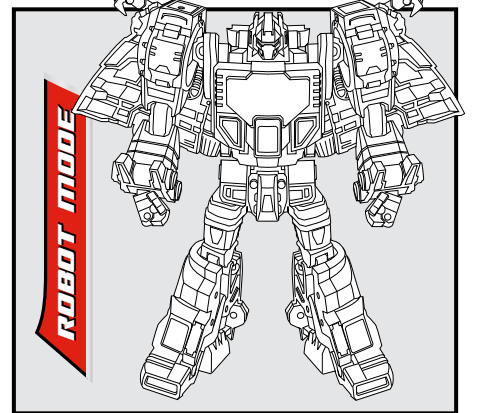
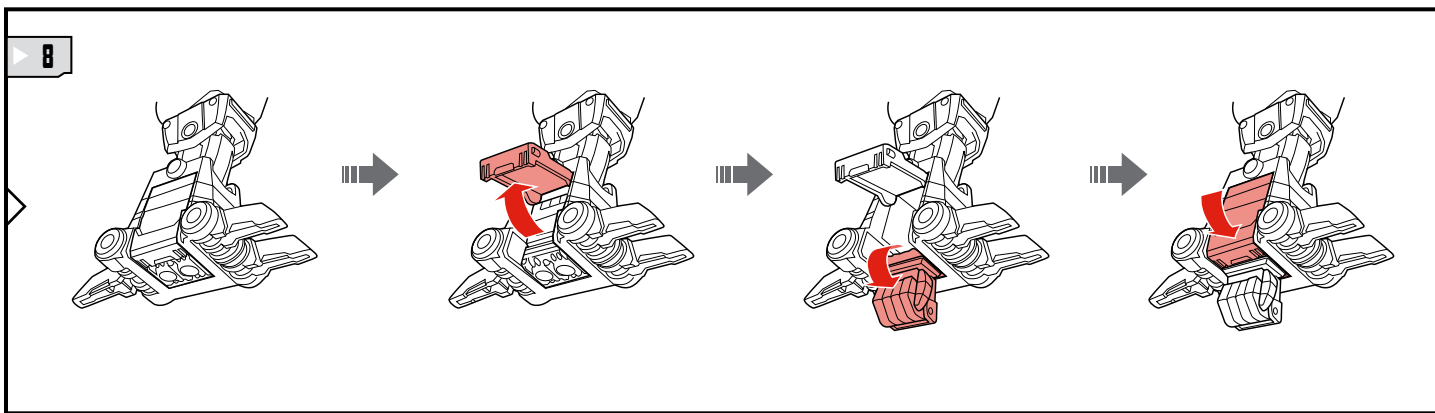
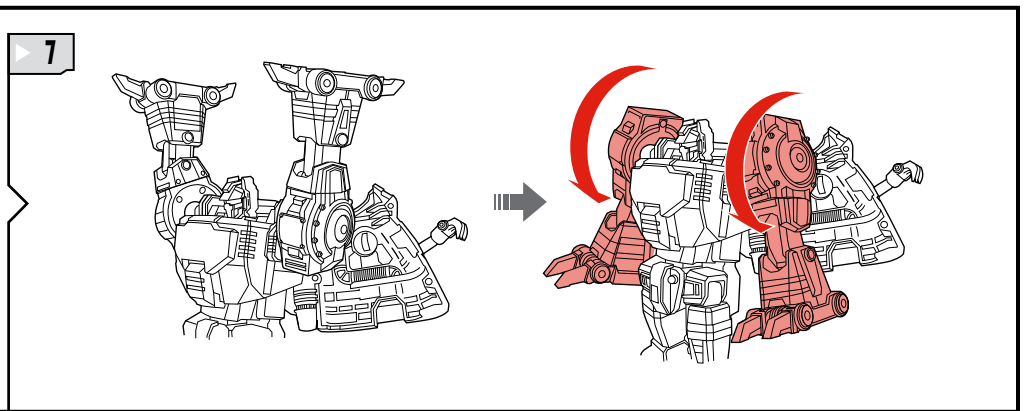
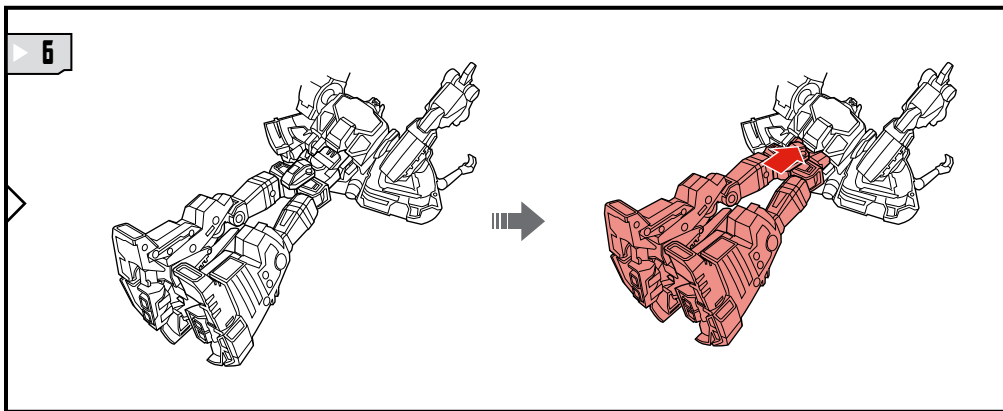
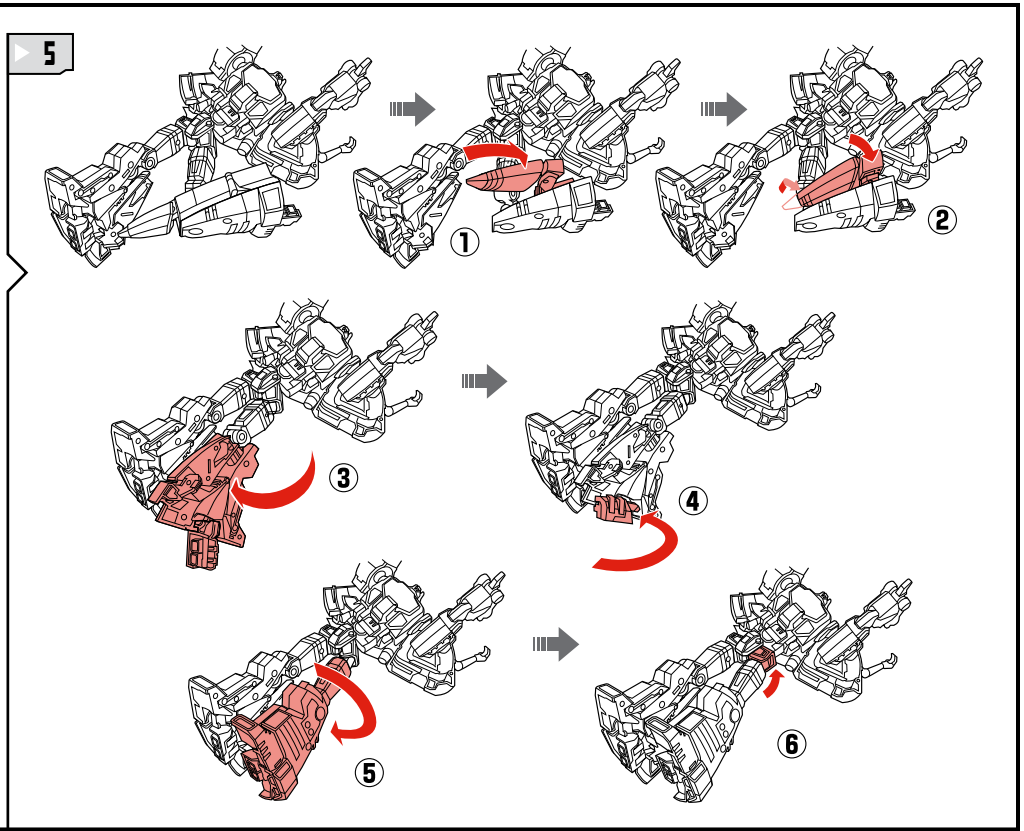
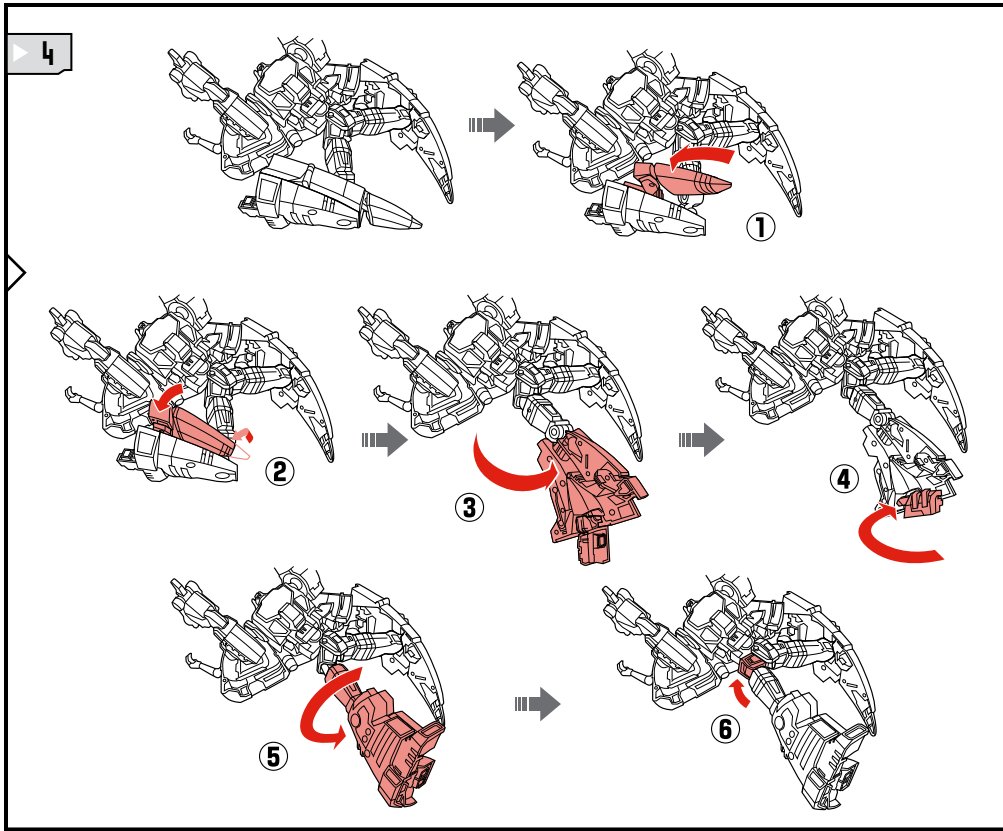
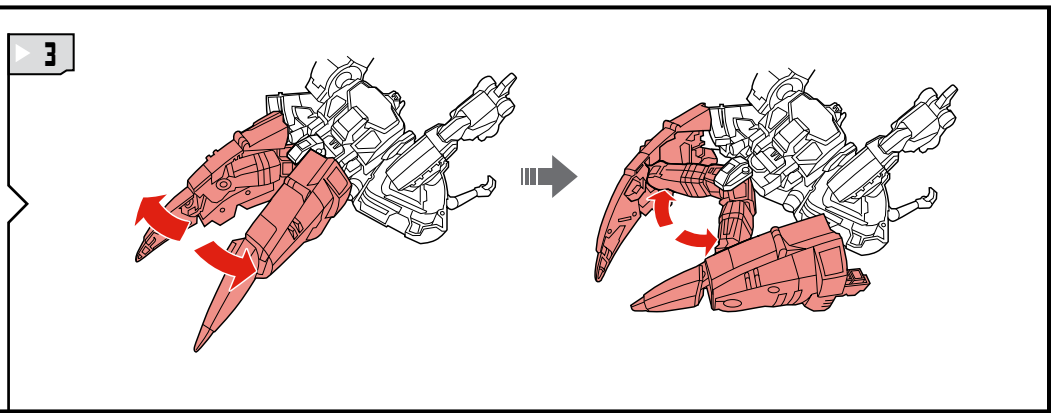
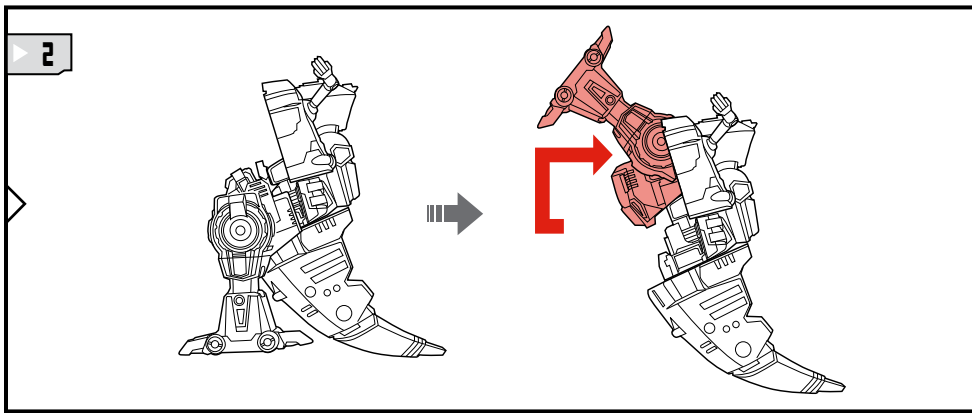
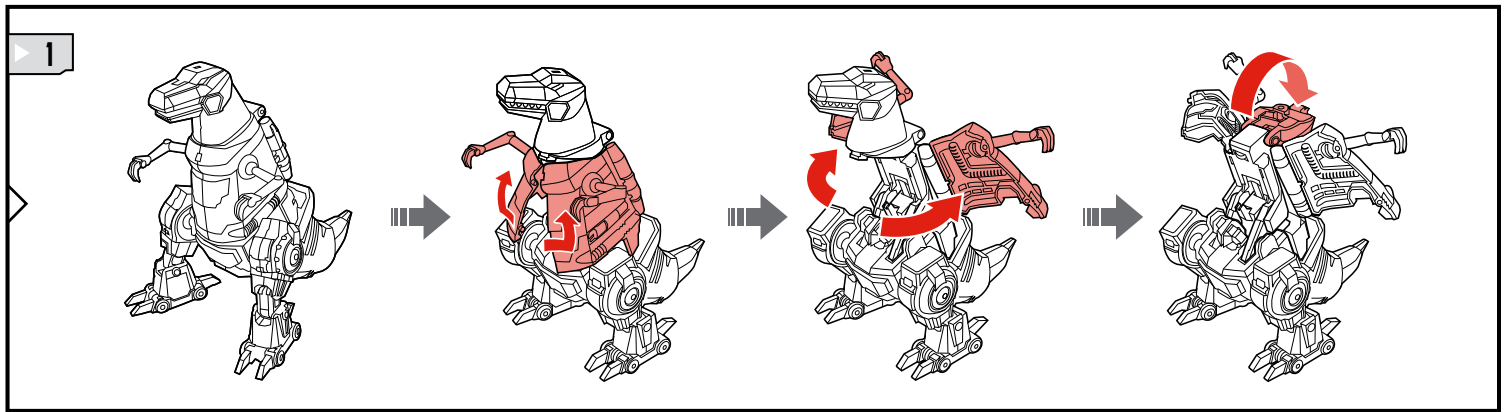
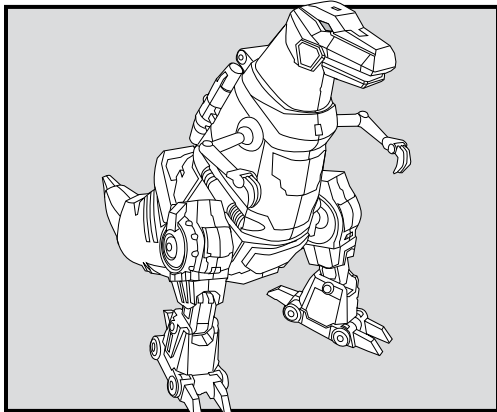

Reverse order of instructions to convert back into DINOBOY®.

CHANGE EYE COLOR

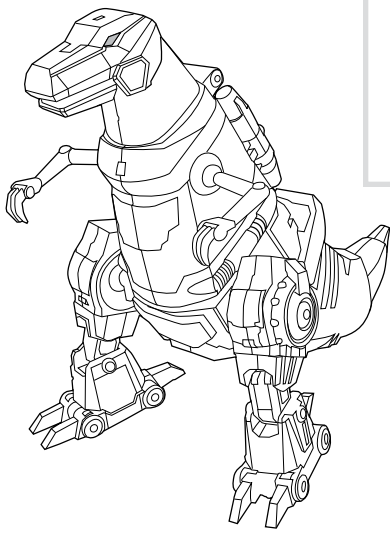
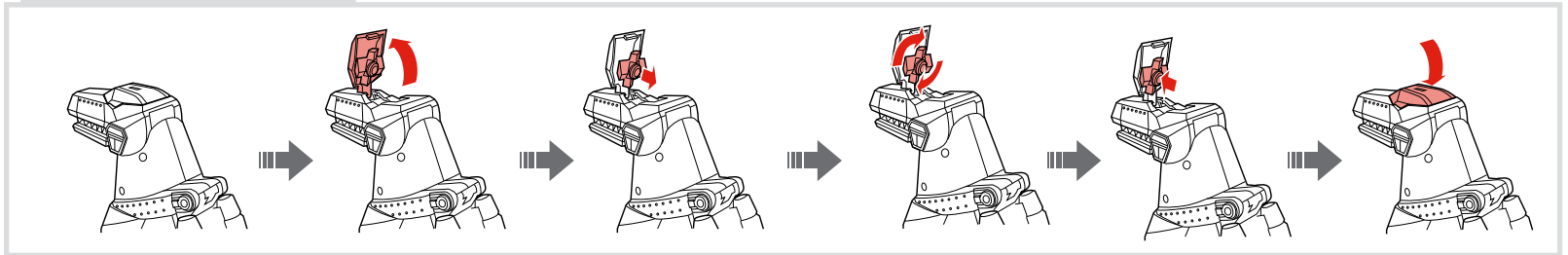

BITE FUNCTION

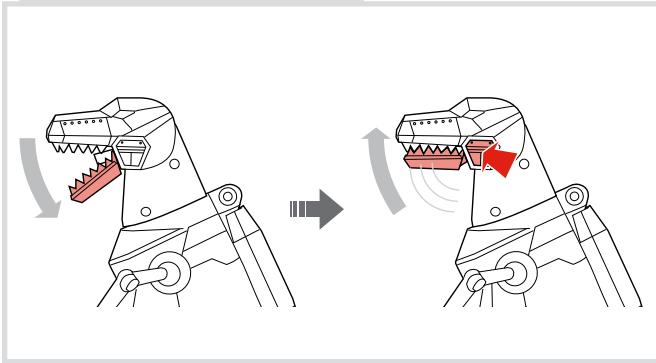

MOVE HEAD

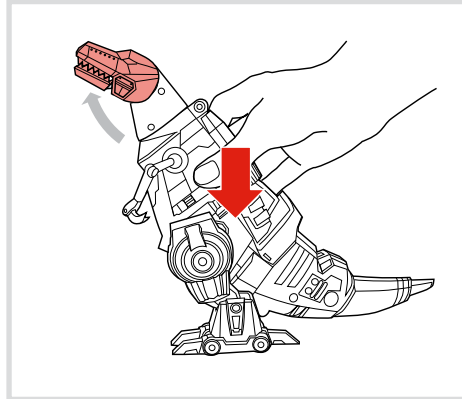

MOVE HEAD

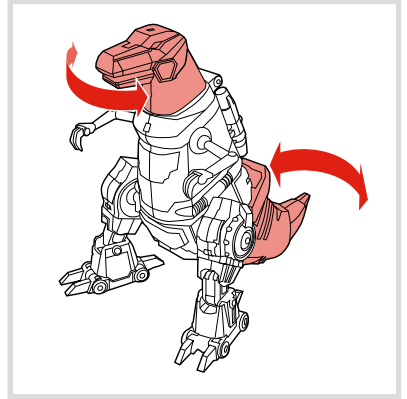

WEAPONS

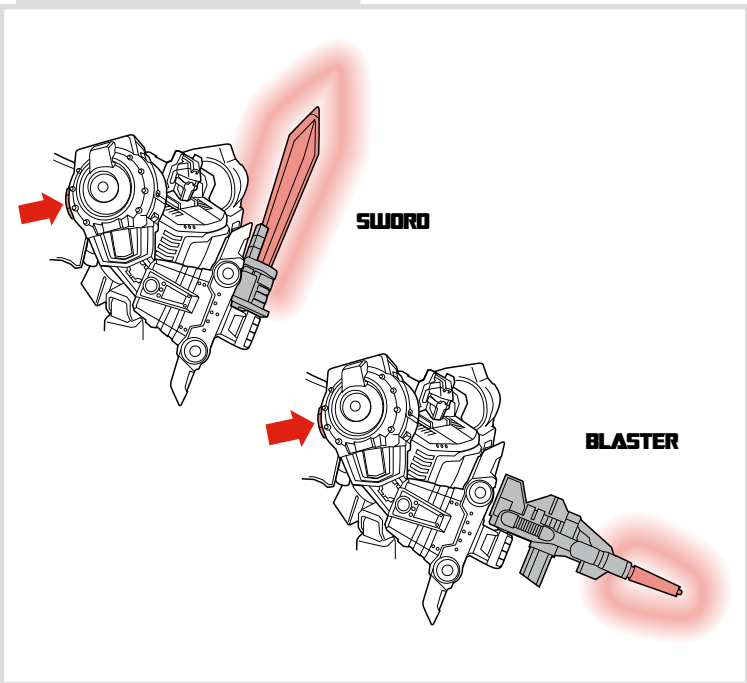

DINOBOT® crown of leadership

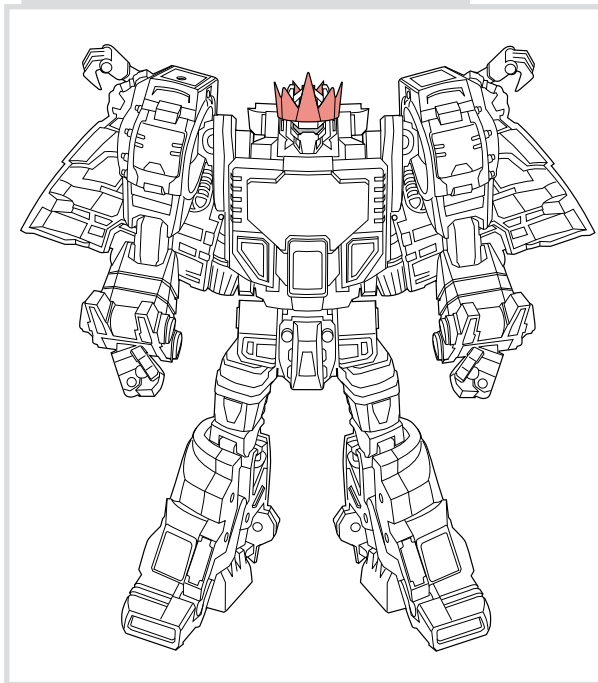

CHANGE EYE COLOR

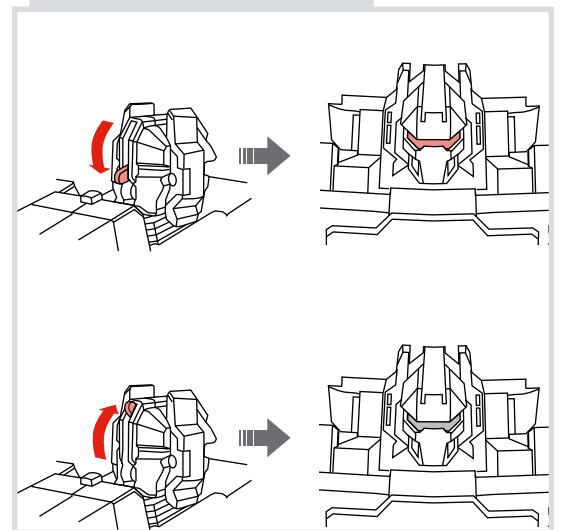

TO REPLACE BATTERIES:

Using a Phillips/cross head screwdriver (not included), loosen screw in battery compartment cover. Remove cover (screw will stay attached). Remove and discard old batteries. Insert 2 x 1.5V "A76" or LR44 button cell batteries. Replace door and tighten screw with screwdriver.

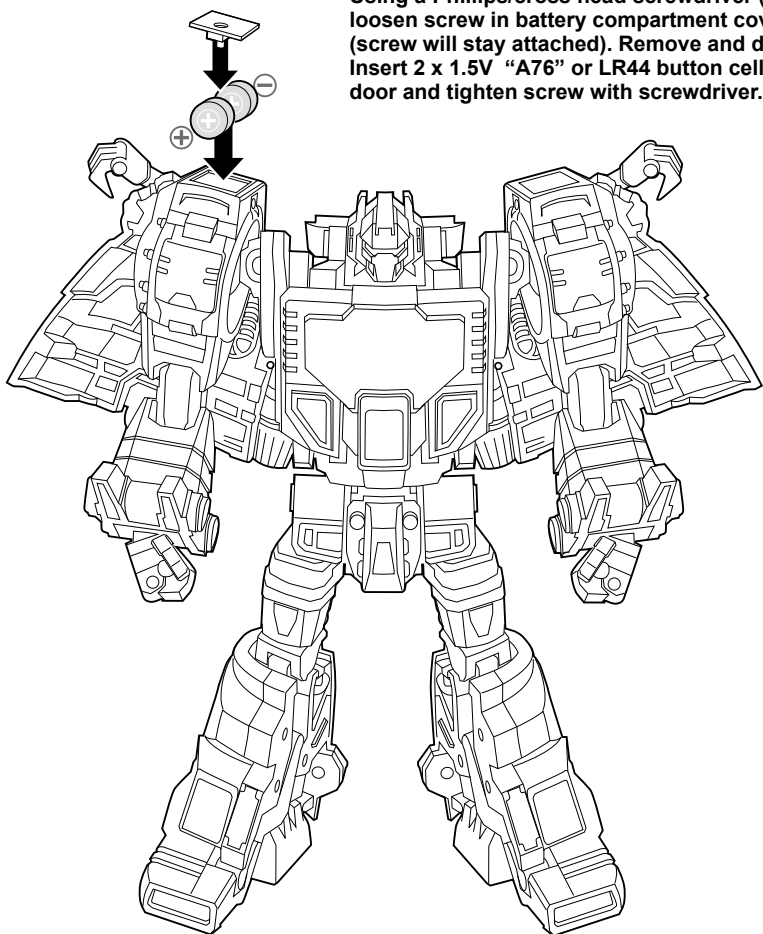

IMPORTANT: BATTERY INFORMATION

CAUTION:

1. As with all small batteries, the batteries used with this toy should be kept away from small children who still put things in their mouths. If they are swallowed, promptly see a doctor and have the doctor phone (202) 625-3333 collect. If you reside outside the United States, have the doctor call your local poison control center.
2. Always follow the instructions carefully. Use only batteries specified and be sure to insert them correctly by matching the + and - polarity markings.
3. Do not mix old batteries and new batteries or standard (carbon-zinc) with alkaline batteries.
4. Remove exhausted or dead batteries from the product.
5. Remove batteries if product is not to be played with for a long time.
6. Do not short-circuit the supply terminals.
7. Should this product cause, or be affected by, local electrical interference, move it away from other electrical equipment. Reset (switching off and back on again or removing and re-inserting batteries) if necessary.
8. RECHARGEABLE BATTERIES: Do not mix these with any other types of batteries. Always remove from the product before recharging. Recharge batteries under adult supervision. DO NOT RECHARGE OTHER TYPES OF BATTERIES.

Retain instructions for future reference.



Some poses may require hand support.
© 2010 Hasbro. All Rights Reserved.
TM & © denote U.S. Trademarks.
Manufactured under license from Tomy Company, Ltd.



Not suitable for children under 3 years because of small parts - choking hazard.

P/N 704320000



NEED HELP?

TRANSFORMERS.COM/INSTRUCTIONS